



TO: Maize Park and Tree Board, Recreation Commission & Staff and
USD 266 staff

FROM: Maize City Staff

DATE: August 7, 2019

RE: Workshop for the Amphitheater at Maize City Park on August 13, 2019

BACKGROUND:

During the 2020 budget process, the Maize Park and Tree Board requested Capital Improvement Project funding for the construction of an amphitheater at Maize City Park. Successful funding of this project was contingent on the receipt of a 50-50 matching grant from the Land and Water Conservation Fund grant.

As part of the Academy Arts District Plan, RDG consultants provided the City with a cost estimate for the construction of an amphitheater. The cost for an amphitheater with a 40' x 60' stage is \$575,000. Funding for the City's portion was provided for by the City Council during the acceptance of the 2020 Budget.

Staff applied for the grant for an amphitheater at Maize City Park. In June 2019, staff was notified that the grant was being recommended for funding from the state committee to the federal committee for authorization of funds. The official announcement will be made late August/September. Engineering and design work will begin later this year; construction will be complete before the end of 2020.

GOAL:

The workshop on Tuesday, August 13, 2019 at Maize City Hall will be an informal roundtable discussion to imagine as many future possible uses for the amphitheater. This will ensure that it is built to be flexible and to accommodate a variety of community needs and functions far into the future.

Excerpts from the Academy Arts District Plan that outlines the vision for Maize City Park as well as an artist's rendering of an amphitheater example is attached to give shape to our discussion, but we encourage out of the box thinking! The ideas generated at the workshop will be translated into a Request for Proposals that will be bid out for the design and construction of the amphitheater later this fall.

We are truly looking forward to working with you at this workshop. Thank you for your willingness to provide input for this project and to contribute in a way that will impact many generations of our Maize community to come!

Workshop Agenda

Joint Maize Park and Tree Board, Recreation Commission and USD 266

Maize City Hall Council Chambers
August 13, 2019 at 5:30pm

Light Meal provided at 5:30pm for all attendees. Please RSVP to jgraham@cityofmaize.org

1. Meeting Format:
 - This is an informal meeting of the Maize Park and Tree Board members, Recreation Commission Board members and staff, USD 266 staff and city staff for the purpose of obtaining direction in the design details that will be incorporated into a “Request for Proposals” for the construction of an Amphitheater in Maize City Park in 2020.

3. Discussion Topics:
 - Amphitheater request for proposals process that considers:
 - Review of National Night Out public feedback from August 6, 2019
 - Review of results of Amphitheater joint meeting on March 13, 2018
 - Types of Events and Facility Demands
 - Amphitheater Design Details
 - Technical Specifications
 - Landscaping and Site Amenities
 - Clair Donnelly Memorial and other Sponsorship Opportunities

4. Objective of the Meeting:
 - To provide a forum for board discussion, input and direction regarding the above topics.
 - Based on discussion, city staff will prepare an RFP for the Amphitheater.

5. Adjournment
 - Meeting will end no later than 7:30 pm.



THE VISION

An expanded and accessible public space for people of all ages (and especially children and students) to have fun, express their creativity, and gather together to experience the creativity and performances of others.

CITY PARK

DESCRIPTION

City Park is the only developed park in Maize with play equipment and shelters. The Community Building within the park offers rentable space for events and gatherings, although only the upper floor is usable. The park is a popular destination for families and close to three elementary schools.

ENHANCEMENT OPPORTUNITIES

In the concept, City Park complements the Artists' Village by providing indoor and outdoor opportunities for art, play, learning, and community interaction. The existing facilities remain with unused spaces enhanced with more community amenities. City Park will be a special place not only in the Academy Arts District but in Maize and the region.

Recommendations to achieve the vision for City Park include:

1. **City Park Gateway.** MOXI Crossing transitions westward across Khedive into City Park. The transition intersection at Khedive Street should be enhanced with safety improvements and gateway features to connect the spaces visually and functionally. Recommended enhancements include:
 - » Gathering Plaza - a space for informal gathering and interactions that spill out from an enhanced east entrance to the community building.
 - » Ramp - a ramp that leads south into City Park replaces the existing steps for a more accessible path into the park.
 - » Lighting and public art features - the east entrance of the community building would use entry features, public art displays, and gateway lighting to welcome in people from the artist village.

2. **Community Building Programming.** The community building remains as today with minor cosmetic enhancements and a secondary bottom floor entrance from the east. The upper level could be reprogrammed for exhibit space featuring kids' art, workshop space, and other cultural uses, while the lower level could provide studio space for a single specialization or artist. Ideally, the community building would be open during regular times for people to use and visit.
3. **Outdoor Art Square.** A square with shelters and outdoor art spaces gives people an opportunity to participate in art, either informally or through organized classes. Possible activities could include pottery, painting, and ceramics.
4. **Redesigned drive/path.** The driveway leading to the Community Building would be modified with colored pavers to function as a dual use space for park users and people who need barrier-free access. The drive loop could also be used for food truck parking, exhibits, or other temporary uses/displays.
5. **Play space and splash pad.** The existing playground space and splash pad remain. A new path loops around the space for all to access.
6. **Parking and Market Shelter.** An expanded the parking lot both increases the number of spaces and provides room for a covered open shelter with a walkway in the center of the lot. The shelter provides a space for farmers market stands, other sales and exhibits, and festival uses.
7. **Amphitheater.** The former ball diamond would become an amphitheater lawn. The structure is located in front of the Maize water tower with some permanent seating in front and a gradually elevated slope to the northwest for lawn chair seating. The slope would be retained by a low seating wall along Academy Avenue, which could include a mosaic mural or other treatment to be a permanent work. The space comfortably accommodates

Figure 3.8: City Park Concept

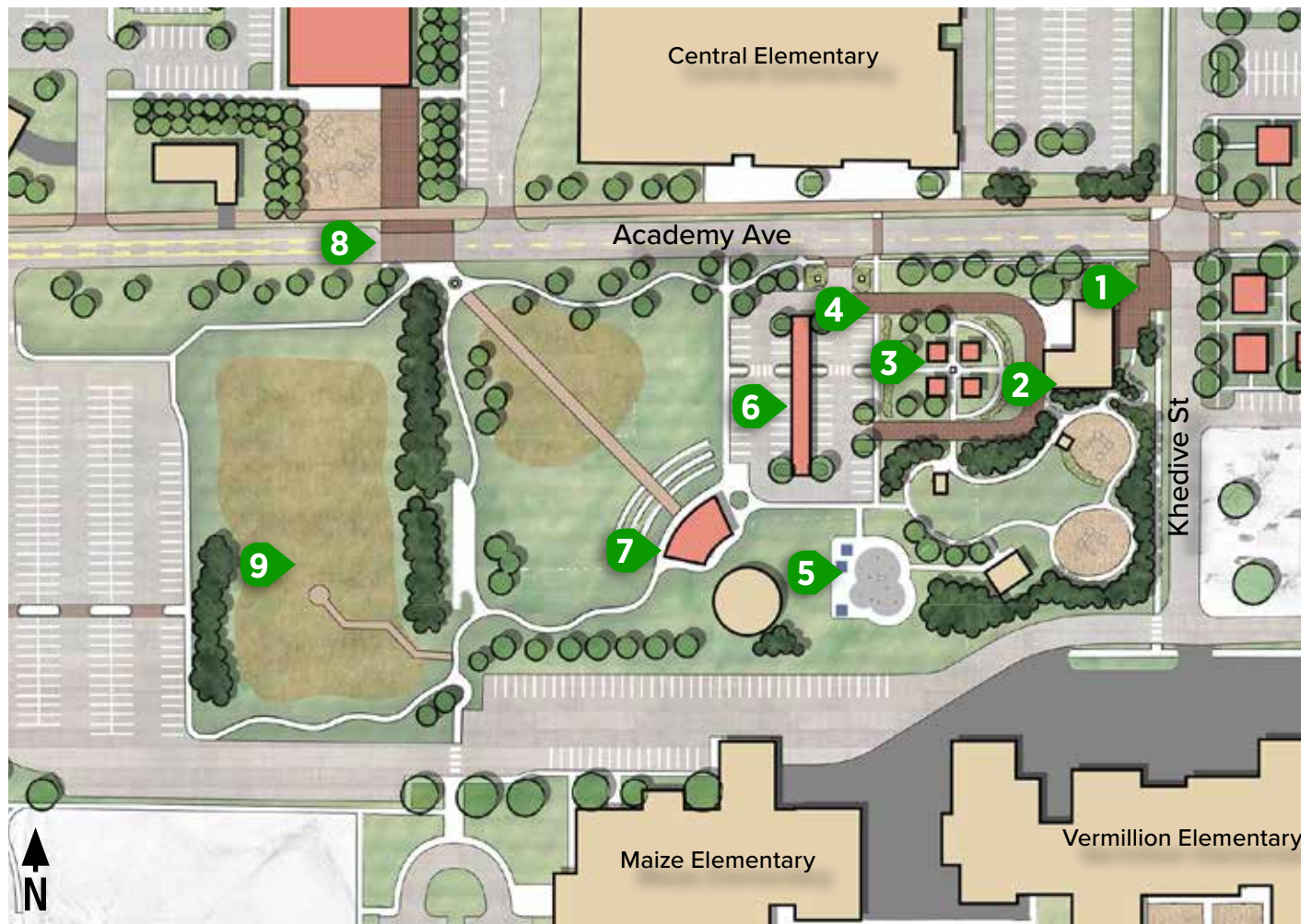

Potential Amphitheater Design



Covered Market Shelter Example



Art Square Example

up to 1,000 spectators. School parking lots can provide overflow parking when events occur during non-school hours, which are likely most event times (i.e. evenings and summer).

8. **Pedestrian Crossing Table.** A pedestrian crossing at the northwest end of the amphitheater lawn provides a connection north of Academy Avenue to future park and recreation space. A colored, crossing that rises from the street surface is recommended to slow traffic and indicate pedestrian crossing priority.

9. **Wetland Park.** The stormwater detention area on the west end of City Park is redesigned into a miniature wetland that provides an active learning environment for park visitors and school classes. A path circles the wetland that could have educational boards about the habitat. A boardwalk extension allows kids to "get close" to nature.